

K- Series *Cast Iron Semirotary Handpump*

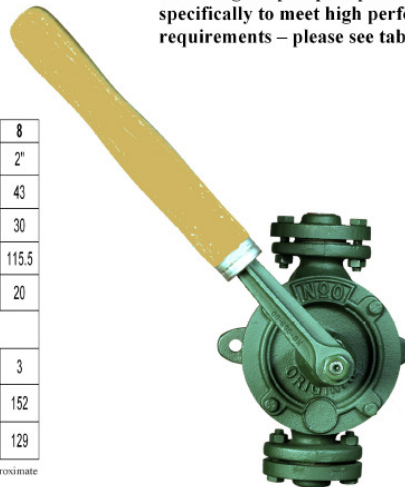

ORIGINAL
QUADRUPLE-ACTING
SEMI-ROTARY HAND WING PUMPS

This range of pumps is produced specifically to meet high performance requirements – please see table below



| Type | 0 | 1 | 2 | 3 | 4 | 5 | 6 | 7 | 8 |
|----------------------------|--|------|------|--------|--------|--------|--------|-------|-------|
| SIZE inches | 1/2" | 3/4" | 1" | 1 1/4" | 1 1/2" | 1 3/4" | 1 7/8" | 2" | 2" |
| WEIGHT* kg | 4.3 | 5.7 | 8 | 10.6 | 15 | 18 | 25 | 33 | 43 |
| DOUBLE STROKES* per minute | 65 | 60 | 55 | 50 | 50 | 45 | 45 | 40 | 30 |
| CAPACITY LPM | 15.6 | 22.2 | 29.7 | 42 | 57.5 | 90.6 | 99 | 103.6 | 115.5 |
| MAX DELIVERY HEAD m | 35 | 35 | 35 | 30 | 30 | 25 | 25 | 20 | 20 |
| PACKING | All pumps are packed in seaworthy wooden cases | | | | | | | | |
| PIECES PER CASE | 30 | 25 | 15 | 10 | 8 | 6 | 6 | 3 | 3 |
| WEIGHT gross PER CASE | 152 | 165 | 143 | 129 | 143 | 131 | 173 | 122 | 152 |
| WEIGHT nett PER CASE | 129 | 142 | 120 | 106 | 120 | 108 | 150 | 99 | 129 |

*This data is approximate

Features:

- * Enhanced output
- * Compact dimensions
- * Highest quality of materials
- * Precision machining and assembly tolerances ensure outstanding performance
- * Water can be drawn from 7m without a foot valve - from 8.5m with a foot valve. The water column (delivery head) for smaller sizes of the pump, although only guaranteed to 35m, is actually in excess of 50m.
- * Each pump is machined individually
- * Each part of the pump is numbered prior to assembly, after which each completed pump is subjected to exacting tests:
 - air suction test
 - air discharge test
 - air pressure test
 - 1 in 5 pumps – real water suction test
- * All pumps are numbered and a full trace can be made on:
 - material supply
 - machining and assembly shifts



Materials of Construction:

- *Cast Iron Body with Brass Internals
- Wooden or cast iron handles
- Teflon gland ring
- Leather joints

Special production:

- *All Cast Iron
- *Bronze Body with Bronze or Brass Internals

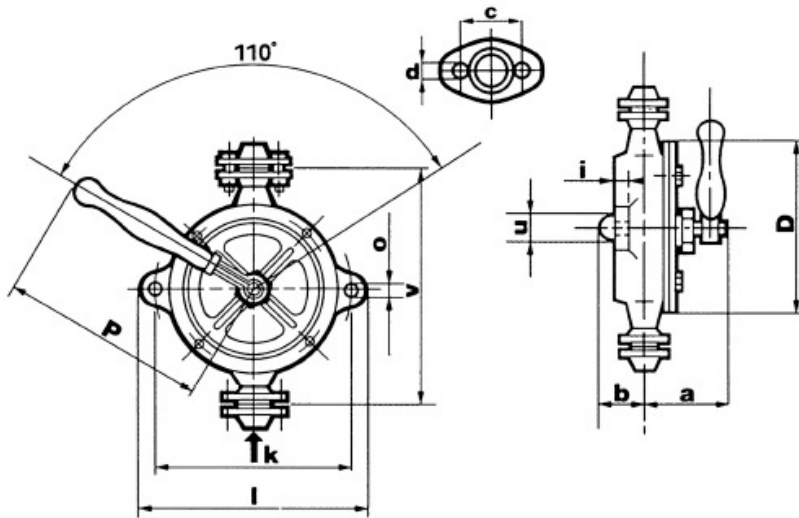
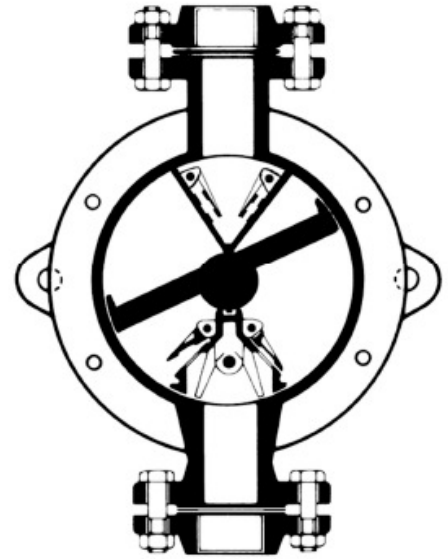

Operation:

The pump is operated by the semi-rotary movement of the handle which activates the wing piston – without flaps but with pierced holes in its axis. Two bridges are incorporated – the lower and upper – both with flaps. Each movement of the handle emits half of the volume of liquid contained in the body of the pump.

| | 0 | 1 | 2 | 3 | 4 | 5 | 6 | 7 | 8 |
|-------------------|-------|-----|-----|------|------|------|-------|------|------|
| D | 118.5 | 127 | 148 | 171 | 194 | 216 | 251.5 | 265 | 292 |
| a | 133 | 157 | 157 | 185 | 194 | 205 | 220 | 240 | 289 |
| b | 59 | 59 | 63 | 72 | 83 | 87 | 91 | 97 | 109 |
| i | 12 | 11 | 12 | 16 | 16 | 16 | 24 | 24 | 20 |
| k | 122 | 135 | 157 | 176 | 197 | 218 | 256 | 270 | 267 |
| v | 166 | 183 | 210 | 239 | 263 | 298 | 334 | 350 | 388 |
| l | 152 | 164 | 190 | 214 | 244 | 271 | 302 | 329 | 320 |
| o | 10 | 10 | 10 | 11 | 11.5 | 11.5 | 12.5 | 12.5 | 14 |
| p | 250 | 350 | 380 | 415 | 495 | 610 | 780 | 800 | 800 |
| u | 36 | 38 | 43 | 48 | 52 | 56 | 60 | 68 | 74 |
| c | 57 | 66 | 73 | 78 | 78 | 86 | 91 | 117 | 120 |
| d | 10 | 10 | 11 | 11.5 | 11.5 | 11.5 | 11.5 | 11.5 | 11.5 |
| in/out BSP | ½" | ¾" | 1" | 1 ¼" | 1 ¼" | 1 ½" | 1 ½" | 2" | 2" |

Dimensions in mm